

# KAYAK FISHING ROD HOLDER MOUNTING INSTRUCTIONS

**READ THROUGH INSTRUCTIONS  
BEFORE STARTING**

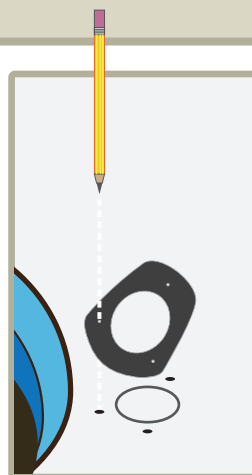
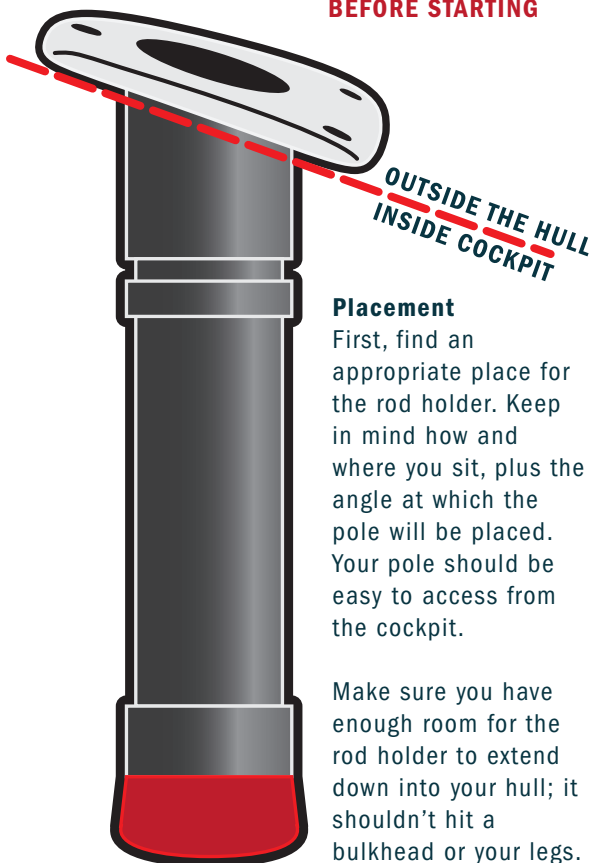

### Step 1

Use your gasket as a template; tape it down lightly at the desired location. Mark the drill holes and remove the gasket before you drill.

Make sure the gasket holes align with what you drill.

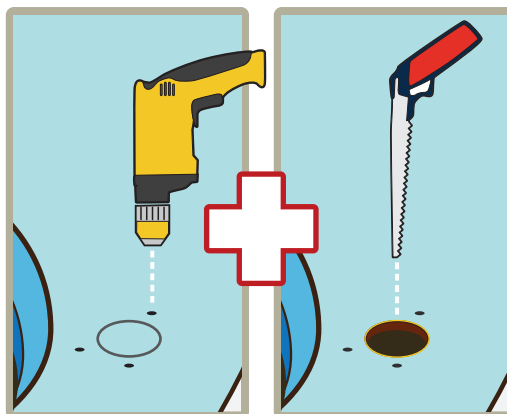

### Step 2

Drill 3/8 in. pilot holes and cut out the center hole. Drill out 1/4 in. screw holes.

Place a thin bead of silicone sealant around the main hole, as well as the screw holes. Place your gasket over the hole. Insert the rod holder and align with holes.

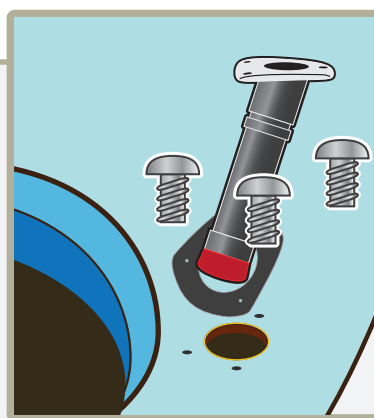

### Step 3

Secure the rod holder to the hull. Make sure the rod holder sits snugly against the deck surface, engaging the silicone sealant. Use 1/4 in. x 1/2 in. stainless steel pan head screws and matching nuts. Steel screws can be used, but expect them to rust eventually.

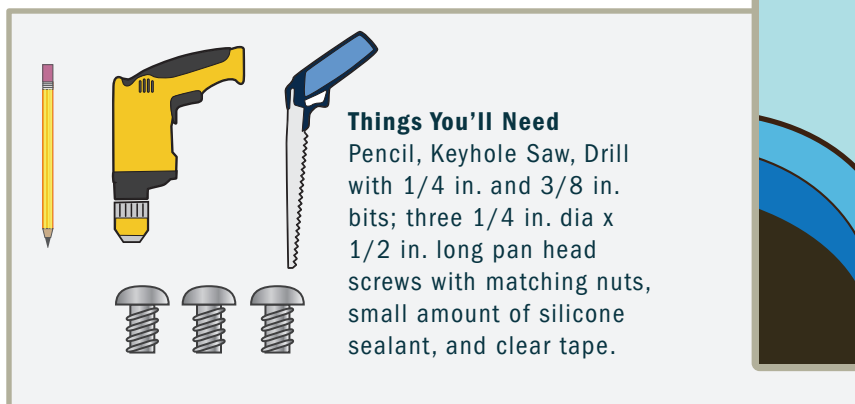

### SEATTLE SPORTS COMPANY

3217 W Smith St. #1  
Seattle, WA. 98199  
© 2011 Seattle Sports Co.

### WARRANTY

Seattle Sports Company are guaranteed for materials and workmanship for one year. Normal wear and tear or damage from misuse, accident or alterations are not covered. Use of this product in a professional setting is not covered. Seattle Sports

assumes no liability for incidental damages or injuries resulting from the use or misuse of this product. You may have additional warranties or limitations outlined in product packaging.